



# Wooden Bedside Locker User Manual

# Virgo, Virgo Lux with tilting table

Thank you for choosing the Virgo Range of Bedside Locker. This user manual should be read carefully before you use your locker, as it contains important information regarding the safe operation and maintenance of the product in order to provide reliable service.

Please ensure that you understand all the instructions thoroughly, and if you have any questions concerning operation and maintenance, then please contact your supplier who will provide you with expert professional advice.

In line with our policy of continuous improvement we welcome any suggestions that could lead to product improvement.

## Contents

1. Introduction
2. Specification
3. Description of Models
4. Locker Features and Using the Tilting Table
5. Delivery and Packaging
6. Safety Instruction
7. Care & Maintenance
8. Accessories
9. Warranty

## 1. Introduction

Your Virgo Bedside Lockers are designed for use by patients in standard hospital wards as well for bedridden patients in Nursing Homes and Residential Homes. Bedside lockers can be used as an additional equipment for nursing care and hospital beds.

You can choose between two models of bedside locker: Virgo and Virgo Lux, which is equipped with a tilting table with height regulation.

Each model of bedside locker, is accessible from two sides, is equipped with a through drawer, a lower locker section and two independently braked castors.

## 2. Specification

	Virgo Lux	Virgo
Overall dimensions Locker height	600 x 485 mm	600 x 485 mm
Dimensions of tilting table Height	865 mm 340 x	865 mm - - - 5
adjustment of tilting top	575 mm 710 –	kg 20 kg
Maximum loading on tilting top	970 mm 2,5 kg	
Maximum load on upper drawer	5 kg 20 kg	
Overall maximum locker load		

### 3. Description of models

Bedside locker Virgo: standard design with a drawer, in the middle there is an open compartment (niche), and at the bottom there is a compartment with a door. The locker is equipped with four castors, of which two are provided with individual brakes.

Bedside locker Virgo Lux: standard design with a drawer, in the middle there is an open compartment (niche), and at the bottom there is a compartment with a door. On one side there is a table with height adjustment and tilting. The locker is equipped with four castors, of which two are provided with individual brakes.

### 4. Locker Features & using the tilting table

The bedside locker is equipped with four wheels, of which two are provided with individual brakes. By actuating or releasing the brake, the locker is either braked or free to move.

The Virgo lockers are equipped with a drawer and a locker. Both the locker and the drawer can be accessed from both sides.

The table top may be tilted and its height adjusted with the use of the mechanism integrated within the locker frame. Whenever you are not using the table, leave this in the collapsed down stored position, inside the locker frame. In this position, the table top does not obstruct any movements around the locker.

#### Tilting the table:

1. Hold the plastic handle on the underside of the tilting table and pull to move the table to its outer position away from the body of the locker.
2. Pull the handle away from the locker frame to tilt the table outside and away from the body of the locker.
3. Pull the handle upwards to move the table to a position for tilting.
4. Tilt the table to a horizontal position as necessary for the patient.
5. In order to return the tilting table to its basic collapsed position, proceed as specified above, but, in the reverse steps.

#### Height adjustment:

1. After you tilt the table from the frame of the locker and bring it to a horizontal position, you can adjust its height.
2. Press the black plastic button and release the table top.
3. After this, pull the table up and bring it to the desired height.
4. After you reached the required height, you can tilt the table in 7 positions according to your needs and purposes

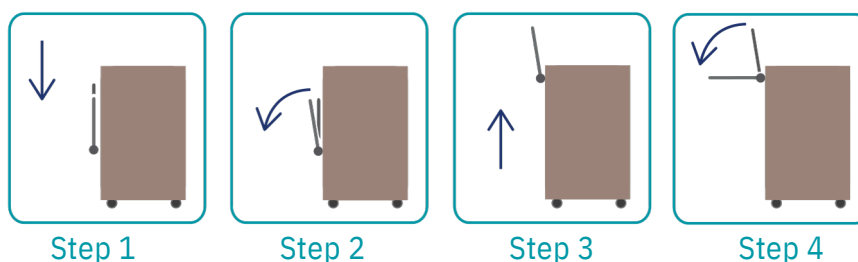

### 5. Delivery & Packaging

Lockers are delivered packed in a protective foil and cardboard. For shipment the lockers are stored on an EU pallet. Any identified defects or damage to the lockers must be notified without any unreasonable delay. All identified defects or damage to the lockers must be immediately reported in writing to the distributor for rectification as necessary. When moving the locker during the process of loading and unloading, it is necessary to make sure that the brakes are released. The locker wheels are designed for use indoors, on flat, smooth and clean flooring (ceramic tiling, linoleum, poured floor, etc.). The wheels may suffer damage when travelling on rough, uneven and dirty surface.

## 6. Safety instructions

1. The locker may be used on smooth and hard surfaces only.
2. The locker's tilting table and drawers must not be subject to any load exceeding the given limits.
3. Do not lean against the tilted table: patients using the table as a support when standing up may suffer an injury or damage the locker and any items kept on it.
4. Use the tilting table and drawers with maximum care in order to avoid jamming the fingers of patients or the staff.
5. The lockers must not be used if any defects have been identified which may be dangerous for the patient, staff, third parties, the locker or the surrounding interior.
6. The appropriate auxiliary Ward Staff shall be responsible for instructing the patient in the use of the locker.
7. Before using the locker, make sure that it is functional and free of any failures.
8. Lockers may be used only by patients who are in an adequate physical and mental state to be able to use the locker safely and without any complications.
9. Repair the locker only with the use of original material and components; when replacing any damaged components with unoriginal or unsuitable materials or components, the manufacturer shall refuse any liability thus incurred.

## 7. Care & Maintenance

### Cleaning.

Clean the locker using a slightly moistened cloth, with a mild detergent. It is not recommended to use any bleach or surface cleaner that may scour the wooden surface.

### Maintenance.

The Virgo lockers are designed to require very little maintenance, however if there are any signs of damage, or the locker is not performing as it should, then please contact your supplier for further assistance. Any maintenance should be only be carried out by suitably trained personnel

## 8. Accessories

- • Metal or wooden handles for drawer and locker
- Lock with a key for locker
- Additional shelves inside the locker

## 9. Warranty

The guarantee period provided for the bed is 24 months from the day of delivery.

The guarantee and post guarantee repairs should be carried out by the manufacturer or by authorized repairmen on the basis of a recommendation issued by the manufacturer.